

CC 9060 Smart



Index

Introductory information	2
1. General	2
2. Security guidelines	2
Installation of the hands-free car kit	4
3. Scope of supply	4
4. Positioning and mounting	6
5. Connections on the electronics box	9
6. Installation of the loudspeaker switch box AC 5120	13
7. Installation instructions for the fuses	17
Operating guidelines	18
8. Using the hands-free car kit for the first time	18
9. Handling possibilities	18
10. Voice control	18
11. Handling via Touch screen	20
12. Establishing a <i>Bluetooth</i> [®] connection	20
13. Menu navigation	22
14. Accepting, making, ending calls	32
Further Information	34
15. Service	34

1. General

Dear customer,

Congratulations on purchasing a BURY hands-free car kit. You have chosen a high quality product that is extremely easy to use. All aspects of BURY production through to sales and service are subject to strict quality management according to DIN EN ISO 9001. All BURY hands-free car kits meet CE and e1 security standards. Furthermore, we provide a two-year warranty on all components.

Please read the operating manual carefully so that you can fully enjoy your BURY hands-free car kit. If you have any further questions concerning installation or operation of your car kit, please contact your dealer. He will be happy to give you reliable advice. You can also contact our hotline. Our phone and fax numbers are listed in the chapter Service at the end of the operating instructions.

Have a good trip!

2. Security guidelines

Installation – who and where



The installation of this system can be carried out by yourself but please observe the installation requirements of the automotive manufacturer (VAS 1978). During the installation, park the car at a place where the road traffic is not impaired. We recommend to let a specialised workshop perform the installation.

Power supply



This system has been designed for the use in vehicles with an on-board supply system of 12 volts (passenger car). If you intend to install the device in a vehicle with an on-board supply system of 24 volts (lorry), please use a voltage converter. If you have queries regarding this subject, please contact our hotline.

Position, volume

Install the components of the device in the vehicle so that your field of vision is not impaired and the components are not mounted in the impact zone of the passenger compartment or in the airbag inflation zones. The removal of coverings (with and without airbags) or components of the dashboard requires – in some cases – special tools and special knowledge.



Intended use

We shall not be liable for damages or malfunctions due to improper use of the hands-free system. Therefore, do not expose the device to moisture, extreme temperatures or shocks and carefully follow the procedure described in the installation and operating guidelines.



Use while driving

Operate the system only when the situation allows it and when you do not endanger, harm, constrain, or annoy other road users. The volume of the device has to be set in a way that exterior noise is still audible.

Faults

Do not commission the device if you detect or assume a defect. In this case, contact a BURY specialised dealer or our hotline. Improper repair efforts can be dangerous for you. Therefore, only skilled personnel may perform inspections.

Important:

- ▶ The driver is ultimately responsible for the safe operation and control of their vehicle at all times. You should never use a hand held phone, including sending or reading text or picture messages, while driving.
- ▶ Research indicates that there is a risk to safety when the driver of a motor vehicle is distracted and using a mobile phone while driving can be a distraction.
- ▶ The manufacturer strongly recommends that you use a hands-free solution when driving.

3. Scope of supply

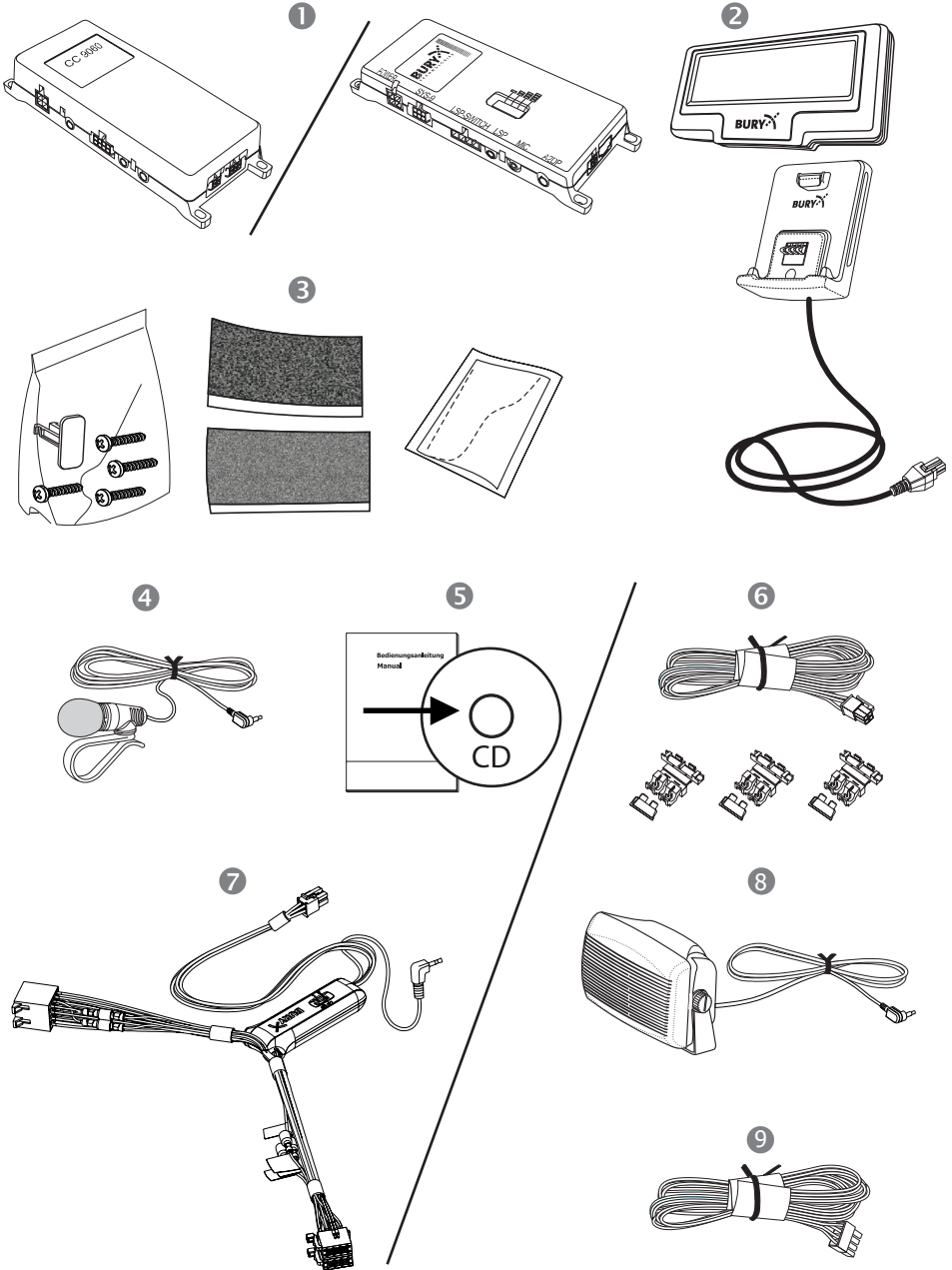

The hands-free car kit (HFCK) is supplied with different combinations of components, depending on the sales regions (countries). The operating manual refers to all versions.

Description of the components:

- 1) Electronics box
- 2) Monitor and installation pad
- 3) Fixing screws for electronics box, rider, adhesive pad, cleaning cloth
- 4) Microphone
- 5) Installation and Operating manual on CD
- 6) Power supply cable with fuses
- 7) External loudspeaker switch box AC 5120
- 8) External loudspeaker
- 9) Loudspeaker connection cable

Version 1:

- Electronics box without integrated loudspeaker switch box
- With external loudspeaker switch box AC 5120

Version 2:

- Electronics box without integrated loudspeaker switch box
- with power supply cable
- with external loudspeaker

Version 3:

- Electronics box without integrated loudspeaker switch box
- with power supply cable
- with loudspeaker connection cable

Hinweis:

- ▶ If certain components are added or omitted you will receive the corresponding information on a separate enclosure.

4. Positioning and mounting

Step 1:

First of all, please choose the most convenient position for the monitor and the holder in your vehicle by attaching the monitor / hook-and-loop fastener to the pad and checking different positions in the vehicle.

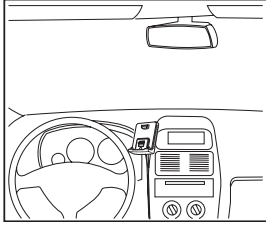

After having found a suitable position for the monitor in the vehicle you can mount / attach the holder accordingly. Please use a cleaning cloth for degreasing the surfaces you want to attach the holder to.

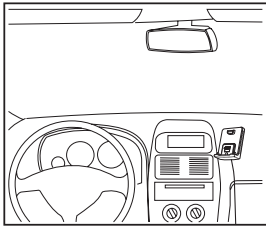

The end of the cable with the small Molex plug is ideally suited for placing through small openings in the dashboard area. This facilitates a practically invisible installation of the cable. Take the length of the cable into account and make sure that it is of sufficient length to reach the intended location of the electronics box.

Important:

► When positioning the monitor please take care that the monitor does not impair the view onto the road, that it will not be installed in the impact zone of the passenger compartment (amongst others in the airbag inflation zones) and that cables may be laid without any problems.

► The holder can be affixed just once, removing could damage the adhesive area. In case of high variations in temperatures - depending on the structure and the features - decolorisations of the surfaces can occur during the subsequent utilization.

► Please avoid direct sunlight on the monitor or high internal temperatures, which can be rapidly reached in parked vehicles. In such cases, remove the monitor of the hands-free car kit from the cradle and put it in the car glove pocket or glove box for instance.

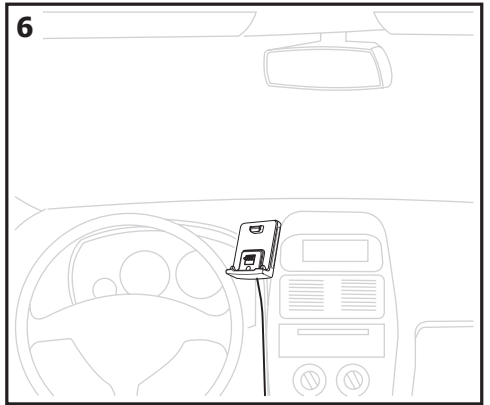
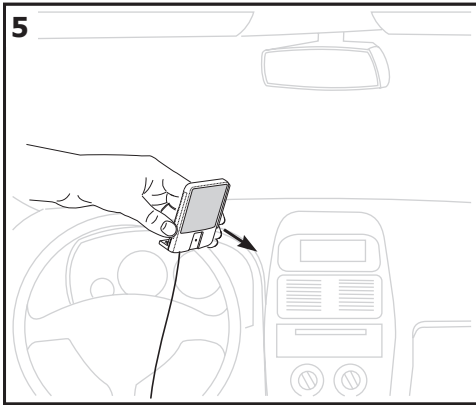
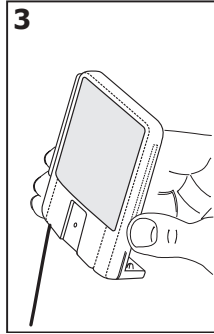
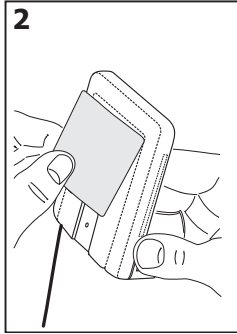
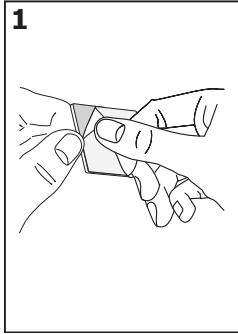

Example of installation:

Step 2:

Depending on the vehicle type and its equipment (e.g. airbags), it is reasonable to install the microphone either at the A-pillar, at the sun shield or at the roof interior. For details about the equipment features please refer to the vehicle documents.

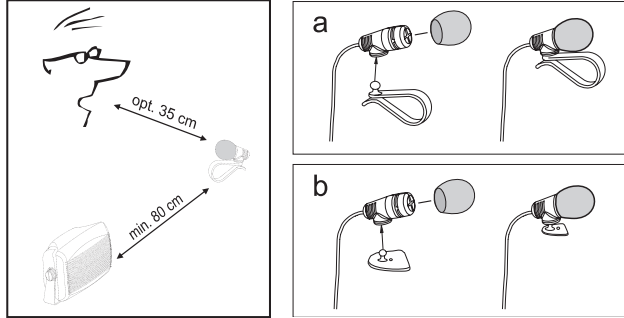

Step 3:

Please lay the cables in a way that they do not lie/hang unsecured in the vehicle and that they may not influence the conducting of the vehicle. When laying a cable, please take care that it is not under traction stress but that it has some tolerance. Avoid crushing the cable as damages of the insulation can be caused by friction/rubbing.

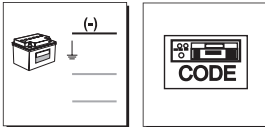

Step 4:

Install the electronics box at a convenient place in the vehicle. This can e.g. be behind the radio, in the glove box, or in the centre console. Please mind that you can access the connections of the box without difficulty. Before connecting the components to the electronics box you should branch off the battery for safety reasons. In doing so, take into account that there might be a radio coding (confer radio manual).

Important:

► Please install the electronics box behind a cover or somewhere you can only reach by opening or unfastening a protective cover / a cover. The terminal box must not hang loosely in the vehicle.

5. Connections on the electronics box

With the combinations of the product versions, different electronic boxes can be used. These differ in terms of the arrangement and number of the connections and in terms of their dimensions. Box 1 is eventually going to be completely replaced by Box 2.

The additional components of the hands-free car kit are connected to the electronics box. The following connections are provided:

Box 1

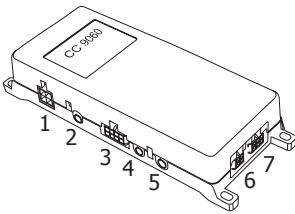

Box 2

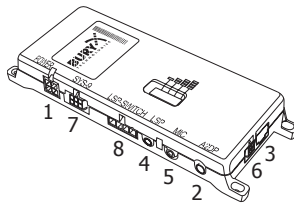

Connection options:

- 1 Power supply
- 2 Aux Out
- 3 Port for additional Accessory
- 4 External loudspeaker
- 5 Mikrophone
- 6 Monitor
- 7 basePlate System 9 adapted for CC 9060
- 8 Internal loudspeaker switch box
(with or without an internal switch box, depending on version)

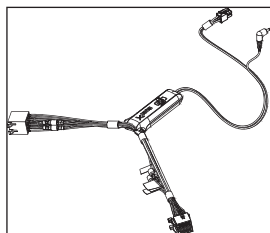

1 - Power supply

Version 1:

Refer to the separate chapter: Installation of the audio switch box AC 5120

Note:

► If the DIN ISO plug of the AC 5120 does not fit in your vehicle, numerous adapters are available from dealers.

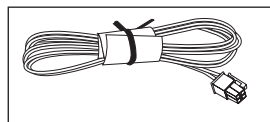

Version 2 and 3:

The power supply of the hands-free car kit is established via a 4-core cable (no. 6). Connect the black (clamp 31 – minus), the red (clamp 30 – steady plus) and the blue cable (clamp 15 – ignition plus) to the power supply of your radio (where required via the cigarette lighter or the fuse box). After connection to the counterpart, the yellow cable provides for radio muting during a phone conversation. Please connect the white Molex connector with connection 1.

Attention:

► If you also connect the blue cable to clamp 30, the hands-free car kit will be permanently supplied with power. If the vehicle is not running for a longer period, this could lead to a discharge of the car battery.

2 - AUX-Out connection

Stereo music is output at connection 2. Here you can connect the AUX-In input of your radio (if existent) via adapters available at local retailers. For the connection to the hands-free car kit, the adapter must have a 3.5 mm stereo jack. Depending on the car radio, the other end must be selected otherwise. If your radio does not have an AUX-In, you can use the car CD/MP3 adapter from the BURY accessories programme to enable the reproduction of music via your radio.

3 – Connection for additional accessories

At this connection you can, for instance, connect a special 3 key remote control from the BURY accessories. Please ask one of our specialist retailers or contact our hotline for further information.

4 - Voice output of the hands-free car kit

Version 1:

Refer to separate chapter: Installation of the audio switch box AC 5120

Version 2:

Connect the external loudspeaker here if you do not want to or are not able to make use of the vehicle's own sound system. When installing the loudspeaker, make sure it is positioned the correct distance from the microphone.

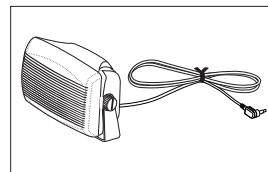

Version 3:

With version 3, this connection remains unused. Please refer to the description for connection 8.

5 - Microphone input

This is where you plug in the microphone jack. After connection 3 has already been occupied use the rider. This ensures that neither of the jacks is able to loosen as a result of vibrations.

6 - Monitor jack

Please plug the 9 pole plug of the monitor connection cable into this jack. Tighten at least one of the two fixing screws hand-tight so that this plug cannot become unplugged as a result of vibrations.

7 - Connection for System 9 basePlate compatible with the CC 9060

This is where you connect the basePlate for the System 9. This base-Plate is specially adapted for the electronics box of the HFCK. The basePlate is supplied with power via the electronics box. You can charge your mobile phone here and also leave it here for safekeeping.

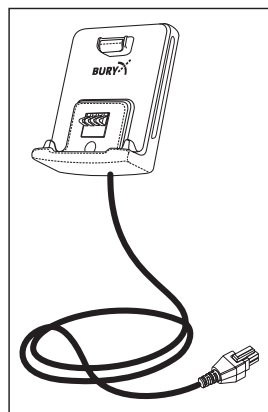

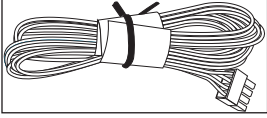

8 - Internal loudspeaker switch box

The cable provided serves the purpose of transferring the voice output to one of the loudspeakers in the car. In the best case scenario, this speaker should be on the passenger side of the vehicle in order to provide sufficient distance from the microphone and to prevent possible echoes from occurring. The jack plug (no. 4) remains unused during the use of the internal loudspeaker switch box.

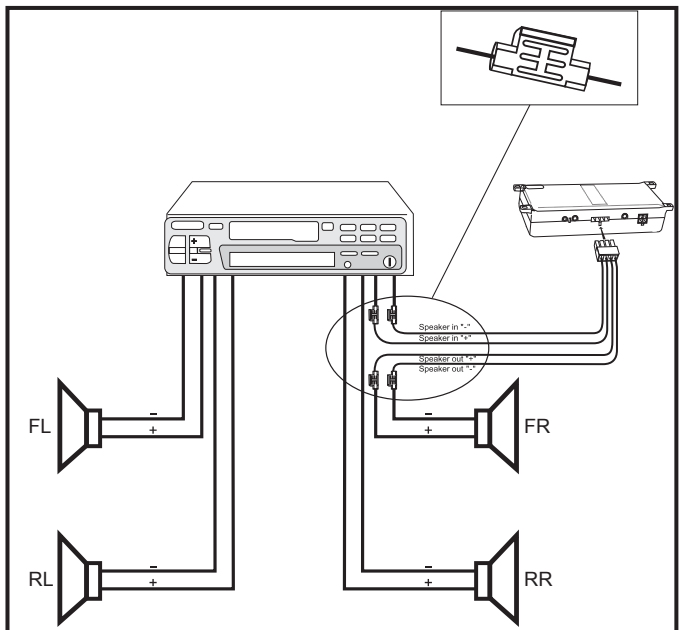
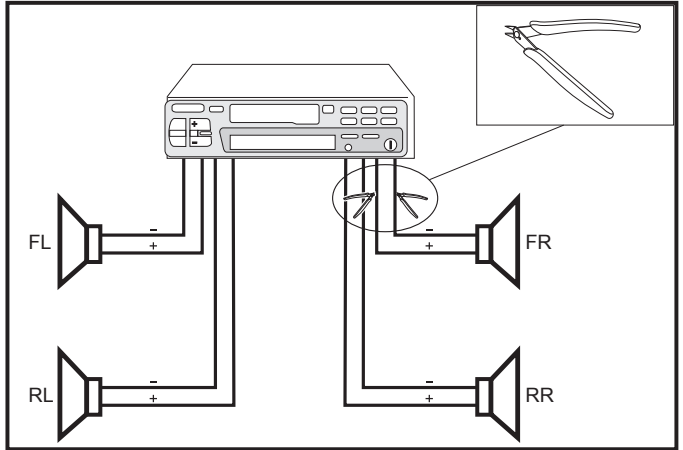

6. Installation of the loudspeaker switch box AC 5120

With the AC 5120 speaker switch box, you get the possibility of being able to mute the feedback of your car radio / CD player etc. and to transfer the voice output of your conversation partner during a telephone call to your vehicle's speakers. This means that the installation of additional speakers isn't required. If your radio has a mute function, then the vehicle speakers are turned onto mute using the radio. If your car radio doesn't have this function, then the signals will be suppressed by the speaker switch box. You can use the AC 5120 through the connections that your BURY hands free car kit offers, which guarantee voltage supply via molex plugs and also have a speaker output.

If you want to make a telephone call in the hands-free mode, your car radio will be automatically switched on to mute. The Audio switch box now uses one or two loudspeakers in your car for the telephone conversation, even if your radio is switched off. This function will be automatically activated after the installation of the unit, there are no subsequent manual settings required.

Some mobile phones do not support a radio mute function. Please read your telephone user manual for more details. You can find out more detailed information at your specialist retailer, in the internet under www.bury.com, or over our telephone hotline.

After checking that all the cable lengths are sufficient, decide where you are able to attach the Audio switch box. Now secure the Audio switch box so that it isn't able to flap about and/or rattle against other parts of your vehicle.

Connect the white power out cable connector (1) of your Audio switch box to the power supply socket of your hands-free kit. Now connect the audio switch box plug (4) to the hands-free car kit. (The other, smaller box is used by the plug for the microphone.)

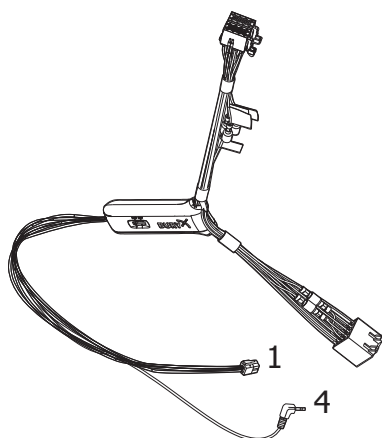

Now disconnect the (a) and/or the (b) loudspeaker connector from the speaker socket on the radio at the back. Connect this connector with the suitable socket (3) on the AC 5120. Now connect the plug (4) with the radio.

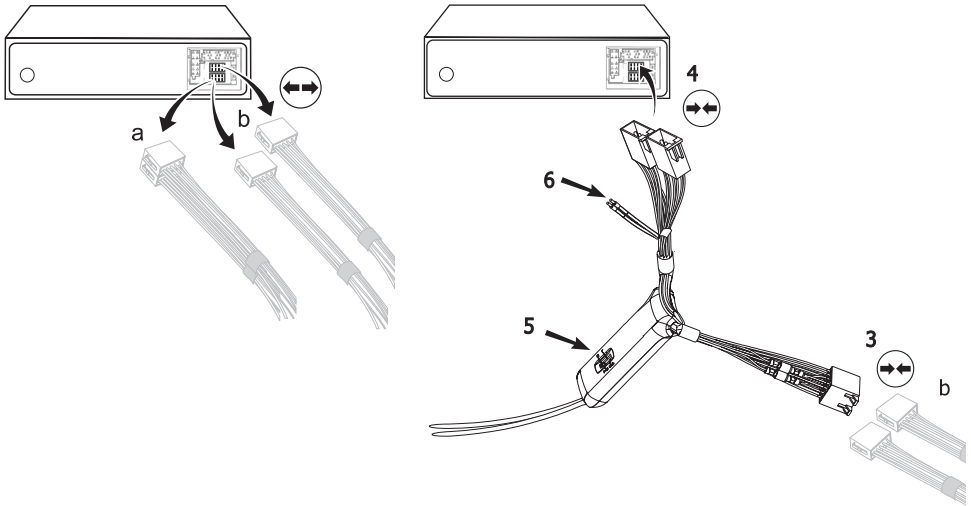

Depending on the switcher position (5), the voice of your conversation partner will be fed back through either the front right speaker, the front left speaker, or through both of the front loudspeakers. The 'OFF' position is to be selected if you connect the switch box to the radio using the 'Phone-IN' cable (6).

The two 'Phone-In' cables are marked accordingly and must be plugged into the appropriate connections on the radio (blue, green or yellow). In this regard, please refer to the instructions concerning the connection configuration of your car radio in your car radio handbook. In lots of radios, the volume level (feedback of your conversation partner) can be controlled via the phone input and the selection of the loudspeaker.

Different connections of the ISO plug on the radio

The layout of the pins on the ISO plug used in a car depends on the type of car. Before using the switch box, you should make sure that the connections are correct in order to prevent possible damage to the device.

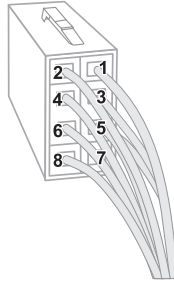

Configuration I

If the assignment of pin 7 of the ISO plug is connected to the DC Power Supply, and pin 4 is connected to the ignition, you should check if the connection looks like the connection presented on the drawing below.

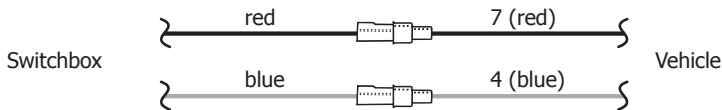

Configuration II

If the assignment of pin 7 of the ISO plug is connected to the ignition, and pin 4 is connected to the DC power supply, the connection of the cables should look like the connection presented on the drawing below.

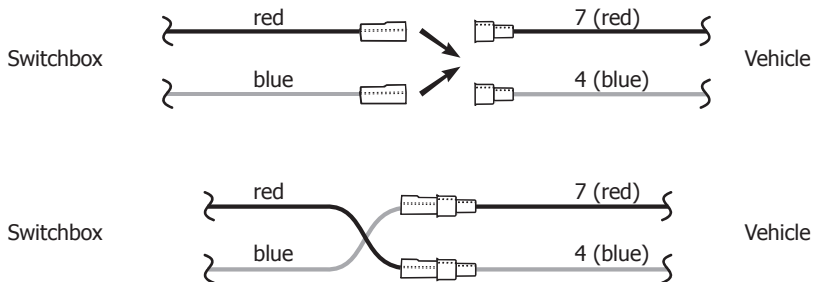

In the operating manual of the radio device, you can find the pin assignment for the "mute" signal. This signal can occur on one of three cables marked with "mute1", "mute2", or "mute3".

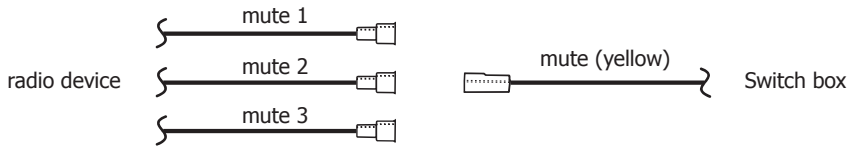

Connect the yellow "mute" cable to the switch box using the correct cable from the car radio: "mute 1", "mute 2" or "mute3".

Attention:

► The positive wires and ignition wires are protected in the casing of the switch box with 3A fuses. For this reason a separate fuse, as shown in the next chapter, is not necessary.

7. Installation instructions for the fuses

If you install the hands-free kit without the AC 5120 switch box then the power supply must be secured with a fuse in the way described below.

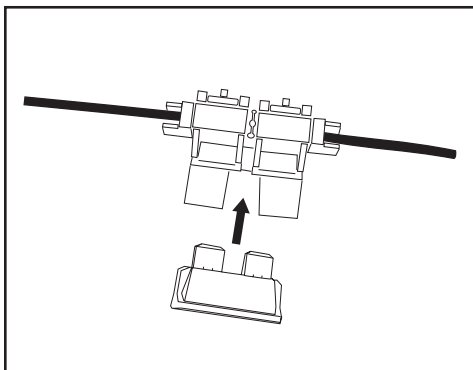
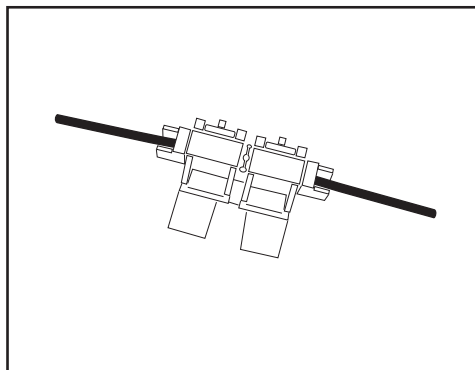
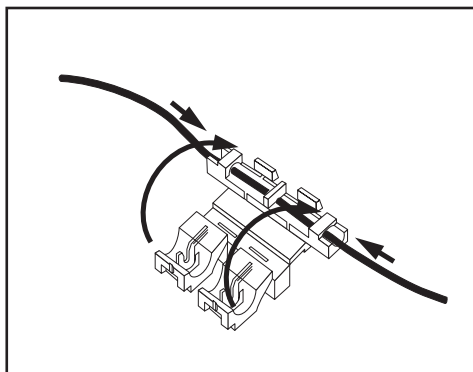
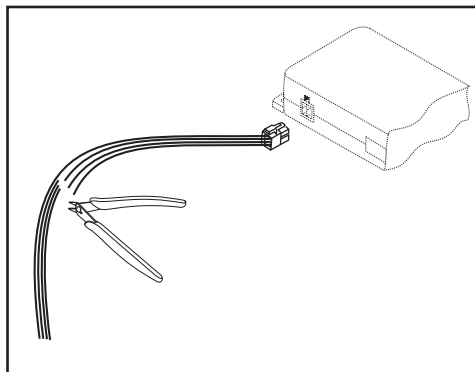

Please cut through the red, the black and the blue cable by means of a wire cutter or scissors. Now insert the two endings of the red cable resulting from the cut into one of the binders, then close it. If you hear two clicking noises, the clamp snapped in properly. Now insert one of the fuses and then repeat the procedure with the other cables.

8. Using the hands-free car kit for the first time



After power supply of the hands free car kit (HFCK) is successful connected, the HFCK is activated when you have started the vehicle.



After this, you have to select the menu language if several are available for you to select. Regional differences may occur in this context. If the HFCK is only equipped with one language then this should load automatically.



You can select other languages using the arrows on the left or the right. Once you have found the menu language that you want, you select it by highlighting the text in the touchscreen.

Startscreen without paired telephone

You can change the menu language again by selecting the **More** touchscreen field, then selecting the **Settings** in the **Head menu**, and then changing the **Language** in the **Device** menu item.

9. Handling possibilities

The system can be operated in two ways:

1. Operation using voice control



Voice dial commands

The „**VOICE COMMANDS**“ are highlighted in the further explanatory notes.

2. Handling via the touch screen



Touch screen

10. Voice control

The menu items of the HFCK can be selected using voice commands once this function has been activated. There are exceptions, however, when you still have to use the touchscreen. During an active telephone call, for instance, you can't use voice commands. You have to select any additional functions using the touchscreen.

To start the voice control feature, briefly press the head symbol down on the main menu. In certain situations, however, with an incoming call

and activated voice recognition for instance, the HFCK will start the voice control system automatically. The HFCK signals that it is ready to receive a command by emitting an acoustic signal.

If you aren't sure of the right command to use, then simply state „**HELP / WHAT CAN I SAY**“. The HFCK will then read out the commands available for the particular menu in which you currently find yourself. If the HFCK fails to understand one of your commands, or the particular option isn't available, the help function will start automatically and list the possible commands.

Please remember that certain commands are only available if a telephone is connected with the HFCK. When entering voice commands, please ensure you speak naturally, clearly and at a regular speed.

Note:

► With the use of the voice control it is recommended to turn down the volume of components which are independent of the audio system (e.g. a navigation system) or to switch off the broadcast of traffic jam warnings in order to avoid unintended voice entries.

In addition to these commands, the HFCK recognises the numbers from zero to nine. Numbers which are larger than nine must be spoken individually (e.g. 10 = one, zero). To search in the phone book, the HFCK recognises the letters „**A**“ to „**Z**“ as well as the NATO alphabet. For the entry of telephone numbers abroad, the command „**PLUS**“ is also available.

When using voice control, in **all menus** these four commands are always available:

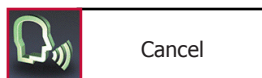

breaks off the current action

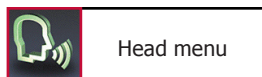

back to head menu

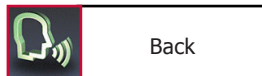

one step back

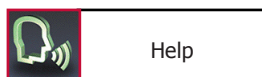

names all commands which are available

11. Handling via Touch screen

The display is divided up into several zones. In almost all of the menus you can find symbols on the left and the right with which you are able to initialise functions directly or browse through in the menu. In the centre of the display you nearly always find two lines of text with menu items which you can also select by pressing them briefly. To scroll up or down one menu level or to go back, please press the upper entry for two seconds, or the blank line above.

Here are two examples:

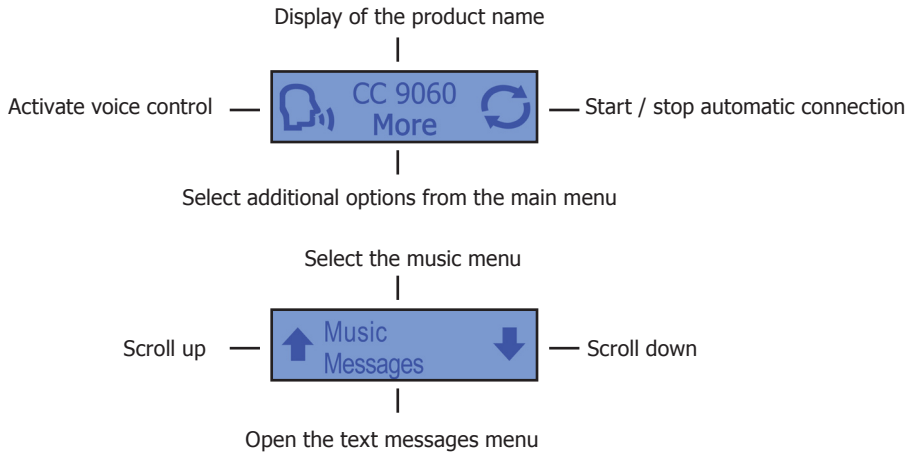

Note:

► Please be sure to clean the display as necessary using a damp lint free cloth. Please do not use any detergent.

12. Establishing a *Bluetooth*[®] connection

If you wish to establish a *Bluetooth*[®] connection between your mobile and the HFCK for the first time, you have to activate the *Bluetooth*[®] function of your mobile phone and search for *Bluetooth*[®] devices. In this case, search for a device labelled „CC 9060“. If several devices were identified, please select the HFCK and enter the PIN number 1234. The *Bluetooth*[®] connection (pairing) will then be established between your mobile phone and the HFCK. It is possible that you will also have to click on 'connect' or 'allow data transfer' on your mobile phone if you want to be able to make a connection.

With a connection which has successfully been made, the name of the coupled mobile telephone and of the provider (stays visible) will be shown and the data from the telephone book (SIM card) and the address book (storage of the telephone) are transmitted to the HFCK. Depending on the amount of stored data, this can take a few seconds. If the synchronisation of the phone book is interrupted, e.g. though an incoming call, it is possible that all entries will not be transmitted. If this happens, the phone book should once again be manually synchronised.

Note:

► The telephone book on your mobile phone is generally synchronised by the hands-free car kit at regular intervals. For the duration of this short moment, the voice control will not be available to you and you will receive a corresponding message.

If it is not possible to establish a connection, please check and update the software release (firmware) of your mobile phone or of the HFCK. You will find an overview dealing with this subject on the Internet at www.bury.com.

Note:

► In the internet you can find an overview with a large number of mobile telephones which have been tested with this hands-free car kit. Please note, however, the use of firmware which deviates from the list and is installed on a listed mobile telephone can lead to the fact that certain displays and functions are no longer possible or only possible to a limited extent.

In addition it is possible that you must delete all devices connected to your mobile phone first in order to enable a correct identification of the HFCK and the establishment of a connection. If you have queries regarding the menu navigation, functions and operation of your mobile phone, please refer to the operating guidelines of your mobile phone. Depending on the manufacturer and type, this can differ considerably between phones.

Note:

► If the rechargeable battery of the mobile phone is low, it is sometimes not possible to establish a *Bluetooth*[®] connection.

The HFCK has a memory for the storage of the identification of up to 10 mobile phones. In case an eleventh mobile phone is connected, the oldest entry in the HFCK memory will be cancelled.

If you wish to cancel a Bluetooth connection, you can either disconnect it conveniently at the HFCK or at your mobile phone. In addition, the connection is disconnected, if you move too far away from the vehicle while taking your mobile phone with you and thus leave the reception radius of the HFCK.

Please note that the capacity of your mobile phone's storage battery can quickly decrease when the Bluetooth function is active. If you do not want to use the Bluetooth function anymore, e.g. if you leave the vehicle for a longer period, it is recommended to deactivate this function.



Start screen subsequent to successful connection

13. Menu navigation

Here you will find all menus which are necessary for the operation and configuration of the system. These can be selected through the touch screen or using voice control.

You are also able to select additional frequently used commands via voice control which otherwise first appear later in the menu tree. These are as follows:

„**DIAL JOE BLOGGS**“,
 „**READ NEW TEXT MESSAGE**“ and
 „**READ NEW EMAILS**“.

You can find explanations of these in the corresponding chapters. On the touch screen, the menus can be controlled through a simple touching of the respective field. In the following the individual menu points will be explained.



Dial Joe Bloggs

Dial Joe Bloggs

With this voice command (is not shown on the display) you can immediately call a contact from your telephone book with active voice control.

Note:

► When doing so, it is important that the stated name exactly corresponds with the entry stored in the phonebook. Please note that telephone book entries, which are only shown in capital letters must be spelt out. Example: ADAC.

If the names have been reversed then the command changes to: „**DIAL BLOGGS JOE**“.



Dial number





Dial number

It makes sense to divide telephone numbers in short number blocks of 3-4 digits and to say them this way. At each break, the HFCK repeats the number block and waits for the next number block. After the signal tone you can respectively continue your announcement.

Enter the area code (wait a moment so that the HFCK can repeat the entry). Enter the first numbers of the actual telephone number (wait a moment so that the HFCK can repeat the entry.) Enter the remaining

numbers of the actual telephone number (wait a moment so that the HFCK can repeat the entry). When you have entered the last number block of the telephone number, you can check the complete telephone number once again with the voice command „**PLAYBACK**“.

Here are some more commands:

	Delete all	The complete entry will be deleted, or the previous entry.
	Delete last	The last digit is deleted.
	Dial	A telephone connection is being established.
	Delete group	The last number block will be deleted.

To select this function on the touchscreen, please press down in the centre of the display for a few seconds. A numeric field will then appear in which you are able to select the numbers 0 to 9 and special symbols like plus, star, hash or pause. By pressing C you are able to undo a previous entry.



Numeric field in touch screen mode

Phonebook

Since your phonebook is scanned with the first coupling of your mobile phone with the system, it is immediately available to you and is stored until you delete the mobile phone from the phone list. The telephone book data can of course only be seen or changed by you.

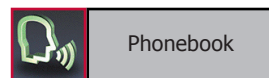

The entire list is read aloud to you. With „**STOP**“ you can stop the process and select the respective entry. With „**NEXT**“ or „**NEXT PAGE**“ and „**PREVIOUS**“ or „**PREVIOUS PAGE**“ you can navigate in the list. With „**DIAL**“ the telephone connection will be made. You can also jump directly to one of the entries shown by activating the entry number. E.g.: „**SELECT ENTRY THREE**“



<Joe Bloggs> is a placeholder for an entry from your phonebook. If you select a name, you go directly to the respective entry.

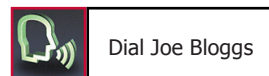

Note:

► Depending on the type of mobile phone, it is possible that the order of the first names and surnames may have swapped around after the telephone book has been transferred.



Fast search

Here you can search for entries through a letter field. Read out the first letters of the first name and surname (depending on the sort sequence) which you want to find. The first entries with this letter will then be displayed.



Get details

Under „**GET DETAILS**“ you will find if necessary all telephone numbers listed under this entry.



Dial home



Dial mobile



Dial office



Dial general



Dial sim

Depending on the settings / contacts in the mobile telephone, you will be shown by the HFCK either the SIM card contacts or the telephone contacts or both.

If your contacts are stored in the telephone's memory, then depending on the type of mobile phone, you can allocate four or more telephone numbers to a single contact. The terms are not standard and may have different designations depending on the manufacturer of the mobile phone, or can be set by you yourself*:

„**HOME**“,
 „**MOBILE**“,
 „**WORK**“,
 „**GENERAL**“.

* This function depends on your mobile phone.



Number

If you say „**NUMBER**“, all stored entries under this name will be read aloud.

In case you have stored more than one telephone number under a name, you can also directly call through the category, e.g. „**DIAL JOE BLOGGS HOME**“.



Voicetag



Store



Delete

In addition you can allocate a phonebook entry with an own voice command (voice tag). This is recommended for names which are difficult to pronounce.

Clearly speak the command into the microphone, the HFCK repeats this and you can then make a call to the desired discussion partner from the head menu with e.g. „**CALL CUSTOMER ONE**“.

In all the HFCK can store 150 voice commands. This voice command (voice tag) is valid for all numbers which are allocated to this name. A corresponding inquiry follows about which of these numbers you want to call.

Note:

► In order to make voice recognition easier for the HFCK, please do not use voice commands for your voice commands (voice tags) which are also used by the HFCK.

Redial

The number which was last selected can be selected once again.

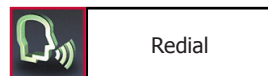

Call lists

Here in a chronologic sequence all calls are listed which have been made, missed or accepted. You can have the telephone number read to you and if you want call back. The navigation within the lists is carried out analogue to that of the phonebook.

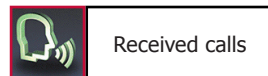

Music

If your mobile telephone possesses the *Bluetooth*[®] profile A2DP, you can play music (e.g. MP3 files) in stereo quality via the HFCK. It is important to play the music title selected respectively on the HFCK via the function ‚play via...’. As the menu navigation of the manufacturers of mobile telephones differs considerably, the designation of the selection ‚...Bluetooth-stereo-headset’ may vary. If you establish this setting, the music is played via the sound system connected to the HFCK.

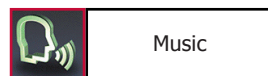

If you receive a call, the playback of the music automatically pauses. The music player fades out and you are able to see the screen with the incoming call.

If you activate the music function via the touch screen, an interface appears in the display with which you can change the volume level and either play back, stop or skip music tracks.



If you activate the music function via the touch screen, an interface appears in the display with which you can change the volume level and either play back, stop or skip music tracks.



The following functions are available for playing and are shown on the display:

- ⏮ Back (title by title)
- ⏭ Skip (title by title)
- ⏸ Pause
- ▶ Play



You can adjust the volume level using the plus or minus key. If you press down and hold the line above the symbol then you will return to the main menu.

Note:

▶ Not all mobile phones support the transfer of the title name.

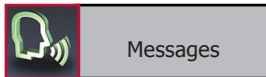

Messages

Using this function, you are able to read out text messages or emails which are saved in the mail box of your mobile phone via the HFCK. The HFCK is able to take and save up to 100 SMS messages and 30 emails from your phone's memory and SIM card. If you receive additional SMS or email messages, then these replace the oldest entries in the HFCK. If it isn't possible for all SMS or email messages to be imported then you will receive an information message.

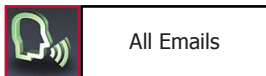
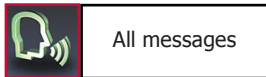

You can access any SMS or email messages which have arrived subsequent to connecting the HFCK with your telephone in the menus „**NEW TEXT MESSAGES**“ or „**NEW EMAILS**“.

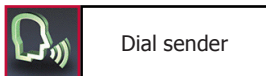

You can select these straight from the main menu with the commands „**READ NEW TEXT MESSAGE**“ and „**READ NEW EMAIL**“ (these will not be shown in the display).

If you want you can call the sender back.

Settings

In this menu point, you can configure the HFCK through five further submenus.



Bluetooth

In the **Phone list**, the telephones are listed which have already been successfully connected with the HFCK via *Bluetooth*[®]. The list is able to hold a maximum of ten telephones. If an additional telephone is connected then the oldest entry is deleted.

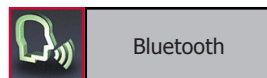

Here, every telephone can be connected, disconnected, deleted or set as the standard. The standard telephone will always be sought as the first telephone if the automatic connection **„AUTO CONNECT ON“** has been activated. From here, the *Bluetooth*[®] connection can also be made via A2DP and the playback of music initiated.



With the **„CLEAR LIST“** command it is possible to delete the full telephone list. You are able to assign an individual **„PIN CODE“** for the Bluetooth connection in the next menu item. Your own code must be at least four figures long – with a maximum of eight being allowed.

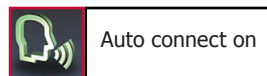
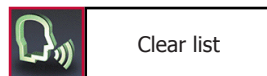

Voice dial

In this submenu you can carry out the following settings:

Activating or deactivating the Advanced Help feature:

If you activate the advanced help, then in certain menus you receive additional assistance during voice control operation about the commands which you are able to use. With other commands, the HFCK will ask you if you really want to complete them.

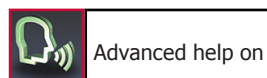
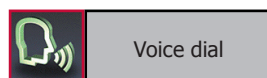

Activating or deactivating the Audio feedback:

If you activate the audio feedback, during the touch screen operation you receive voice support (e.g. the phonebook entries are read aloud to you). Your selection is shown through an information field.

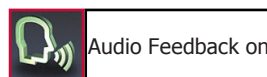



Speaker
adaptation

The HFCK works in general independent from the speaker, that means it can immediately be operated without a ‚voice training‘. Then user training is only needed if you speak a strong dialect. The HFCK reads twenty terms aloud to you which you have to repeat so that the system can ‚get used to‘ your voice.



Decription

Here you will receive short instructions about the essential functions of the HFCK.



Audio

Audio

In this area you have the possibility to change the audio settings of the HFCK.



Disable DSP



Phone DSP



Device DSP



Echo suppression

The HFCK has an integrated digital signal processor (DSP). This serves the functions of voice recognition and voice synthesis and is activated as standard. Together with the suppression of background noise and echoes, the DSP guarantees optimum conversational sound quality for most mobile phones.

Note:

► We recommend that you keep this setting.

If the conversational sound quality should fall, however, you can turn off the suppression of background noise and echoes and leave the DSP devices activated without this function running. Using the first selection you can also completely deactivate the DSP. If this setting also leads to no improvement, you can activate the DSP of the telephone.



Ringtones



Play





Select

The HFCK is sold with four **Ringtones** from which you can respectively select one. With „**NEXT**“ or „**PREVIOUS**“ you can navigate in the list. With „**ACCEPT**“ the ring tone is selected. If you would like to use your mobile phone’s ring tone, please select the first entry in the menu. Please remember, however, that not every mobile phone can transfer its ring tone to the HFCK.

The volume level for the voice feedback and the selected ring tone can be set in an additional sub menu.

Available as voice commands are „**LOUDER**“, „**LESS**“, „**MAXIMUM**“, „**MINIMUM**“ and „**ACCEPT**“.

	Volume
	Speech
	Ringtone

Display

This menu point makes it possible for you to adjust the display in a range of different ways.

In order to avoid the blinding effect especially when driving at night, you can activate the **Sleep mode**. This causes the display to shut off after either 15, 30 or 60 seconds. With an incoming call, the HFCK activates the display automatically.

	Display
---	---------

In the **Illumination** menu item you can change the intensity of the light diodes in the display. As voice commands „**MORE**“, „**LESS**“, „**MINIMUM**“ or „**MAXIMUM**“ are available. The confirmation follows with „**SELECT**“.

	Sleep mode
---	------------

	Illumination
---	--------------

To be able to read the contents of the display optimally during different light conditions, in the next menu item, **Day/Night mode**, you are able to invert the display.

	Day/Night mode
---	----------------

In the **Colour theme** menu item you can adapt the background colour of the display to the colour schemes of the display in your vehicle. Several different possibilities are available. Simply say the colour of the theme and confirm your selection with „**ACCEPT**“.

	Night mode
---	------------

	Colour theme
---	--------------

This product was produced in compliance with the strictest quality criteria. Still in the course of time it can occur that the **calibration** of the display changes (e.g. if touch screen commands are no longer carried out correctly). Then you have the possibility of newly calibrating the display. If you select the Calibrate menu, then you will firstly be asked a security question, and a cross will then appear on the display which you should touch. Please repeat this procedure 4x, then the HFCK is newly calibrated and jumps back to the head menu. Please only carry out this process when the vehicle is standing still.

	Calibration
---	-------------



**Device****Device**

In the **Call answering** menu item, you can make the settings concerning the answering of calls, the menu languages, the telephone book options, for the system itself, and for the willingness to answer calls.

**Call answering**

With the call answering function you can specify as to whether you want to answer an incoming call manually via the touchscreen, by voice command, or automatically. If you select automatic call answering, the call will be answered automatically after two rings. You can then decide whether to accept or decline the call.

**Language**

Depending on the sales regions (countries) the HFCK includes one or several language packages. If several are available you can select the suitable **Language** which you want.

Note:

► Depending on the telephone, it may also be the case that entries are sorted differently. For this reason, some start with the first name and others with the surname. In such a case, this function would not be any help. The maintenance of the data in your telephone, possibly via a PC with the corresponding communications software, can rectify this.

You have to set the language when you use the device for the first time and after updating the firmware or loading factory settings.

**Invert names**

The **Phone book options** menu item can only be selected if a mobile phone is connected with the HFCK. In this option, you are able to invert the names of the entries in your telephone book in the HFCK. For example: Bloggs Joe becomes Joe Bloggs.

Note:

► Depending on the telephone, it may also be the case that entries are sorted differently. For this reason, some start with the first name and others with the surname. In such a case, this function would not be any help. The maintenance of the data in your telephone, possibly via a PC with the corresponding communications software, can rectify this.

You can also import the telephone book manually here once more, if, for example, you saved a new telephone number / contact in your mobile phone during a *Bluetooth*[®] with the HFCK.

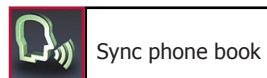

Under the **System** heading, you receive information about the software and hardware installed in the HFCK under **Version info**. If a new item of firmware should become available for the HFCK, then under the menu item **Software update** and using the BURY Update Suite, you are able to update the HFCK.

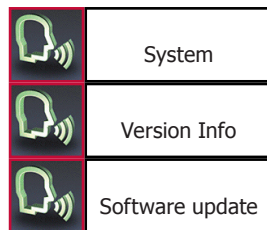

Note:

- ▶ Do not interrupt the power supply of the HFCK during an update.
- ▶ We recommend to let the firmware update be carried out by a BURY specialised retailer.

If you have changed certain settings but the HFCK doesn't work in the way in which you wanted it to, then you can reset the HFCK to the settings which were stored in it when you received it using the **Factory Setting** function.

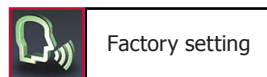

Using the **on-call duty** menu item, you are able to activate the HFCK's internal standby switch. When activated for the first time, this is set at 5 minutes. It can be changed to 10 or 15 minutes, however.

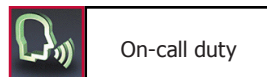

On-call duty is useful if you stay in your vehicle after reaching your destination or switch the engine off when waiting at level crossing, for instance. The hands-free car kit remains active for a set period of time, and you can still conduct telephone conversations via the HFCK without having to look for your mobile phone. In the event of no active phone call, the HFCK will then switch off automatically after the set time has elapsed.

14. Accepting, making, ending calls

You will be alerted of an incoming call via the voice output and the ring tone. Your vehicle's sound system will switch onto mute. If the caller sends their telephone number with the call, this will be shown in the display unless the number is saved in your phone. If an entry for the number is saved in your phone, then the name of the caller will be read out. If the caller hides their number, this will be indicated in the display.



Incoming call

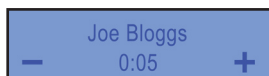

Active call

In the standard setting, you can only accept or decline an incoming call via the touchscreen. If you would like to accept the call, simply press down on the symbol on the left. If you don't want to accept the call, please press the symbol on the right.

During the call, you have the possibility to regulate the volume of the voice of your discussion partner through the **minus(-)** or **plus(+)** field.

By pressing down in the centre of the display you reach a sub menu. Here, you are able to select a **Keypad**, with which you are able to send DTMF tones (e.g. to check on your mailbox).

The **Private mode** is an additional sub menu item. If you activate this, the telephone call is transferred by the HFCK to your mobile phone and it is no longer possible to hear the voice output of your conversational partner over the car's loudspeakers.

Note:

► Please comply with the country-specific laws concerning in-car telephone calls.

With the sub menu item **Mute**, the microphone in your vehicle is muted. You are then able to communicate with a passenger, for instance, without the person who is calling you being able to hear you.

To end a telephone call, press down and hold on the centre of the display for a few seconds.

If you receive another call during an active telephone call, this will be indicated to you both acoustically and visually. If you press down briefly in the centre of the HFCK's display, a sub menu will appear. You can then switch over to the private mode, and you are able to accept or decline a second call on your mobile phone, stop a conversation or initialise functions such as conference calling.

If a telephone conversation is active when you switch off your vehicle's engine, the hands-free car kit will remain running until the call has been ended.

15. Service

In case of general or technical queries, suggestions and comments, please do not hesitate to contact our team at any time:

BURY GmbH & Co. KG
Robert-Koch-Straße 1-7
32584 Löhne

Hotline: +49(0)180 5 - 842 468*

Faxline: +49(0)180 5 - 842 329*

* 0.14 €/min. Deutsche Telekom AG landline

E-Mail: hotline@bury.com

Service desk:

In case of complaints, please return the product directly to our service desk:

BURY GmbH & Co. KG
Im Hause DPD Depot 103
Robinienweg
D-03222 Lübbenau

Information on the disposal of electrical goods in the EU

„The crossed out wheellie bin symbol means that electrical and electronic products, batteries and accumulators must be disposed of separately in the European Union. Please do not dispose of any such products in your normal household waste. As the owner of a product of this sort you are legally obliged to dispose of it at your local dumping site or recycling centre, where you are able to leave your waste electrical goods free of charge. „

Stand 11/2009
25.1161.0-02-201109

Subject to change. Errors and omissions excepted.

Federal Communications Commission (FCC) Compliance Statement -
United States

This device complies with part 15 of the FCC Rules. Operation is subject to the following two conditions:

- 1 This device may not cause harmful interference, and
- 2 the device must accept any interference received, including interference that may cause undesired operation. Changes or modifications not expressly approved by the party responsible for compliance could void the user's authority to operate the equipment.

FCC ID: QZ9-CC9060

Remark:

The CC9060 FCC Label mark is placed on to the electronics box.

Industrie Canada (IC) Compliance Statement

This device complies with RSS-210 of Industry Canada.

Operation is subject to the following two conditions:

- 1 This device may not cause harmful interference, and
- 2 the device must accept any interference received, including interference that may cause undesired operation of the device.

Canadian ICES-003 (Interference-Causing Equipment Standard)

This Class B digital apparatus complies with Canadian ICES-003.

IC: 5927A-CC9060

